

Protecta EX Mortar - Cables in Concrete Wall

System/FPA Register ID# FC194

Installation Instructions

1. Ensure the faces of the aperture opening are free of dust and any other contaminants. The faces may be moistened for better adhesion.
2. The seal can be positioned to either side of the construction or anywhere inbetween.
3. Install a stone wool shutter board to achieve the required thickness of mortar. Make sure that this achieves a very tight seal – any small openings should be sealed with Protecta® FR Acrylic
4. Pour clean water into a suitable mixing vessel and pour enough mortar to obtain the required consistency. Mix well to avoid lumps. Always add the mortar to the water, do not reverse this mixing process.
5. Once the desired consistency is achieved pour or trowel the mortar onto the shutter board making sure that it flows into all corners and around services. Apply a firm pressure to the mortar to eliminate any trapped air bubbles. Build up to the required depth.

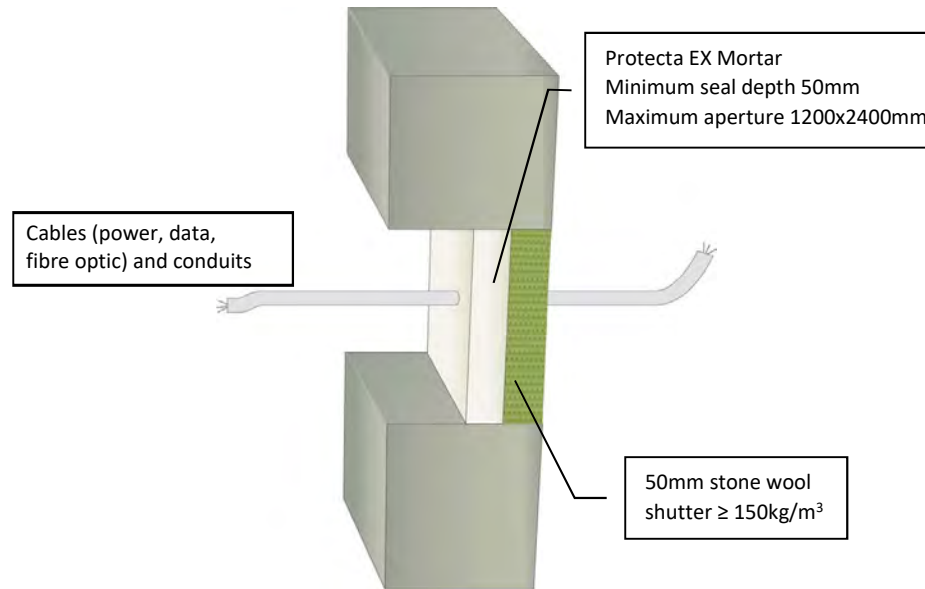

NOTE: Construction shown is for 150mm wall. For 100mm wall position the 50mm stone wool in the centre of the wall and apply 25mm Protecta EX Mortar to each side of the wall.

Minimum separations and limitations

An aperture can include several services, and they may also be different. Services within the system Protecta® FR Board seal do not require a minimum separation, except pipes where pipe insulation penetrates the seal and plastic pipe penetrations which should be a minimum of 30 mm from other services in the aperture. Services should be a minimum of 25mm from seal edges. The total amount of cross sections of services (including insulation) should not exceed 60% of the penetration area. The minimum permitted separation between adjacent apertures is 200mm.

Products	Protecta EX Mortar Stone wool shutter
Application	Fire stopping of cables and conduits in rigid walls
Construction	Minimum wall thickness of 100mm and comprise aerated concrete or concrete with a minimum density of 650kg/m ³ .

Fire & Sound classification

Electrical Cables up to 21mm diam, single or bundled in 150mm wall	FRR -/180/60
Electrical Cables up to 21mm diam, single cable in 100mm or 150mm wall	FRR -/120/90
Telecommunication Cables ≤ Ø21mm single or in tied bundles ≤ Ø100mm in 150mm wall	FRR -/180/90
Steel or PVC conduits ≤ Ø16mm in 150mm walls	FRR -/180/60
in 100mm walls	FRR -/120/60
Non-sheathed cables/wires ≤ Ø17mm in 100mm or 150mm wall	FRR -/120/45
Sound reduction (seal only)	STC 64

As a part of our policy of on-going product development and testing, we reserve the right to modify, alter or change product specifications without giving notice. All information contained in this document is given in good faith and is provided for guidance only. Any drawings provided are for illustrative purposes only. As Polyseam has no control over the methods or competence of installation and of prevailing site conditions, no warranties, expressed or implied, is intended to be given as to the actual performance of the product mentioned or referred to herein and no liability whatsoever will be accepted for any loss, damage or injury arising from the use of the information given.

For all technical details on the products specified please refer to the technical data sheets that can be found on www.firestopcentre.co.nz

Signed and approved: